

ZMetrix Impedance Probes

Zmetrix provides many different probe configurations. The following probes are considered standard, and are generally in stock. Other configurations are also readily available, but are not listed here. For more information on non-standard probe availability, please call your Zmetrix distributor, or the factory.

For customers who are familiar with probes sold by Polar Instruments, a comparison table is provided at the end of this document.

Probe pin polarity for each probe is identified as follows:



Part Definition:

IP	-	X	-	XXX	-	X	-	X
		S - Single		Ohm Value		Configuration		Pin Type
		D ó Differential				(See Configurations below)		B- Bull Nose C-Conical

Examples ó **IP-S-50-1-B** Single Ended, 50 ohm, configuration 1 Bull Nose Pins
IP-D-100-1-C Differential, 100 ohm, configuration 1, Conical Pins

Single-Ended Probes (2 Pin)

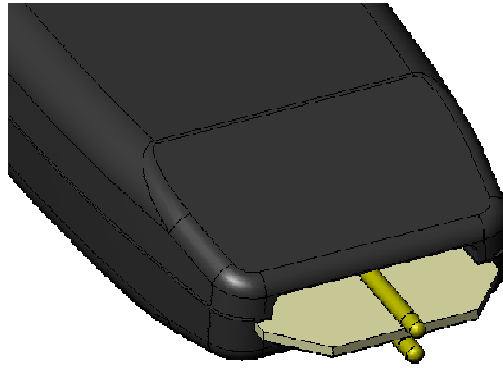

IP-S-50-1

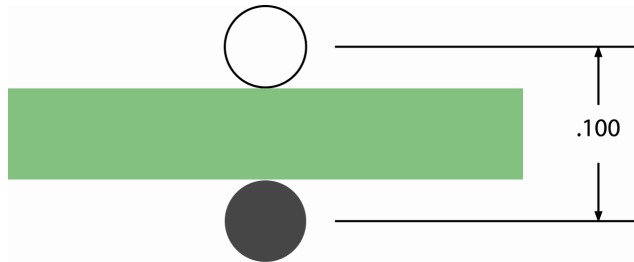

IP-S-50-2

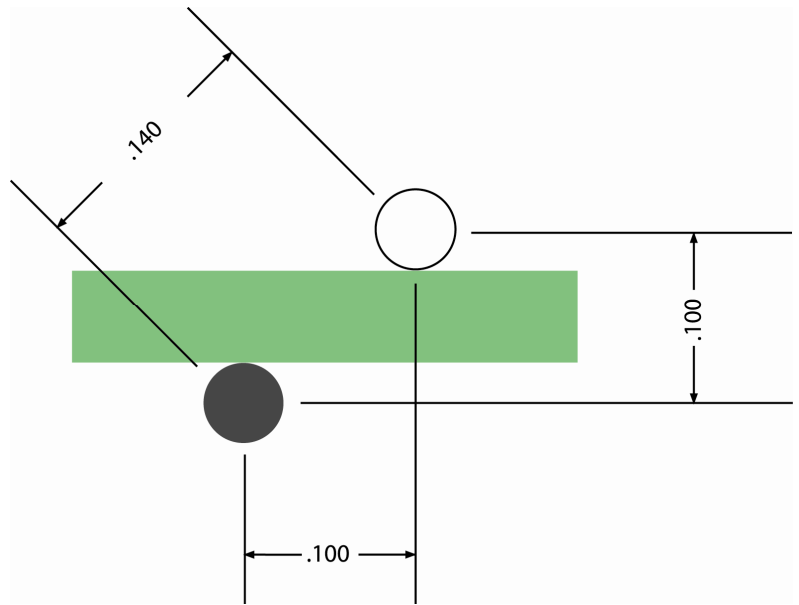

IP-S-50-3

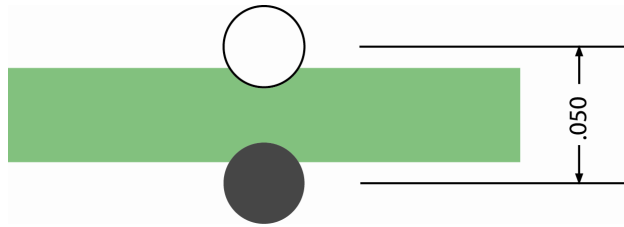

IP-S-50-4

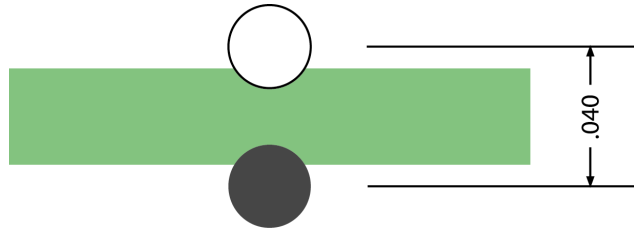

IP-S-50-5

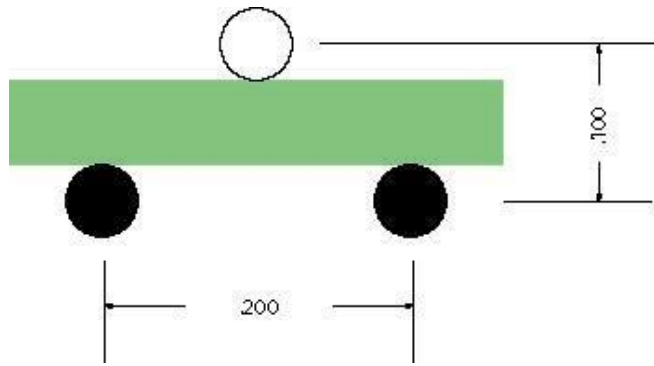

IP-S-50-6

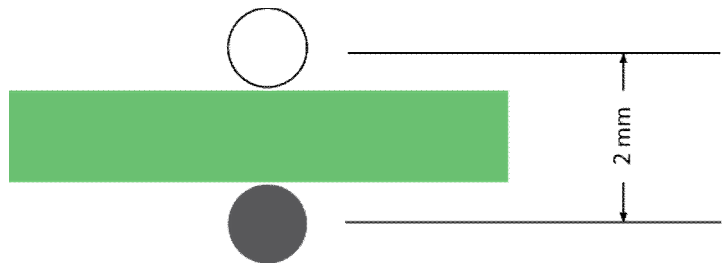

IP-S-50-7

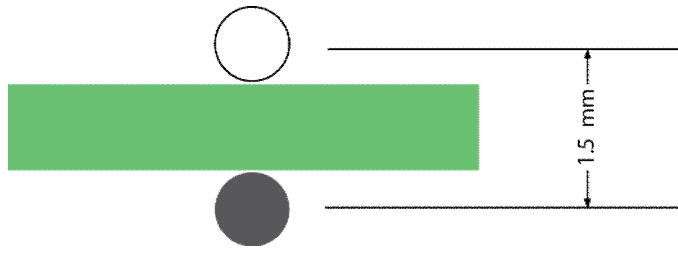

IP-S-50-8

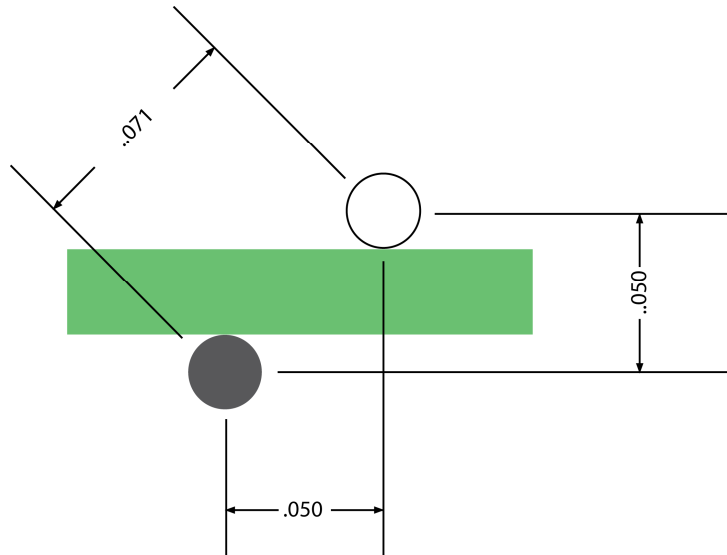

Differential Probes (4 Pin)

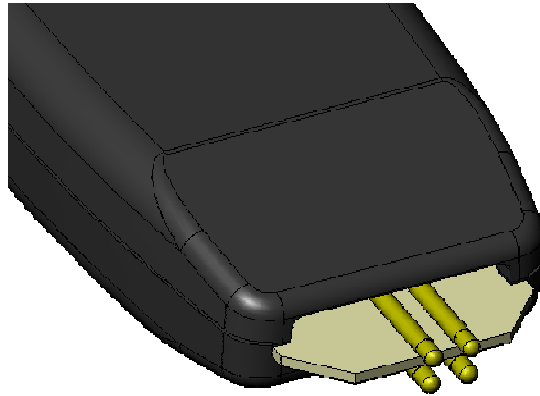

IP-D-100-1

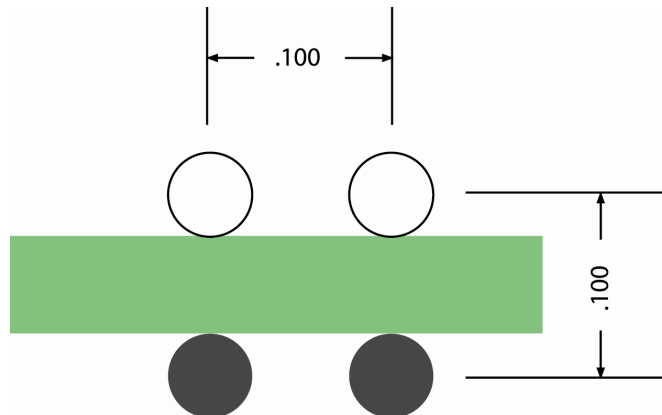

IP-D-100-2

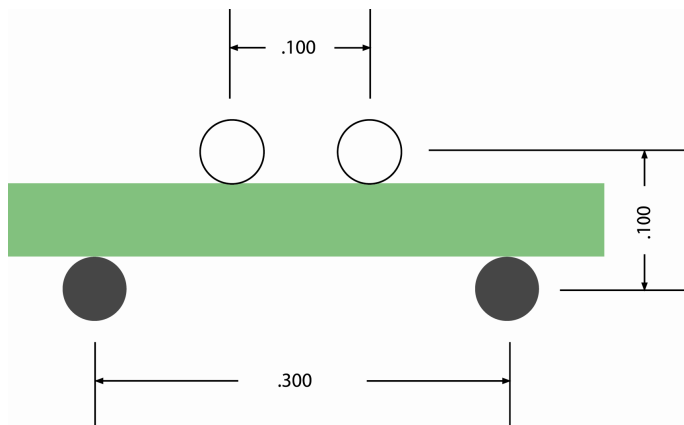

IP-D-100-3

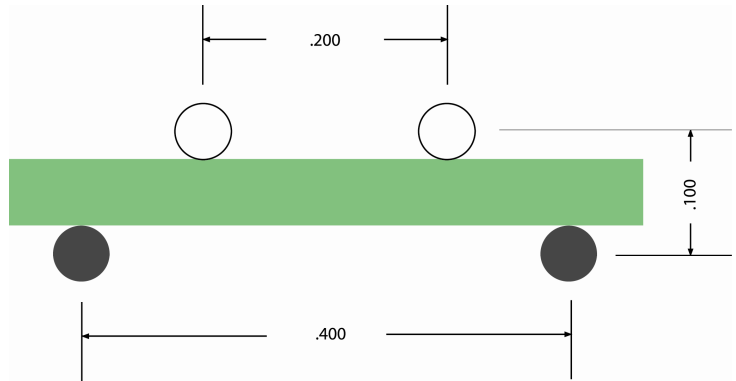

IP-D-100-4

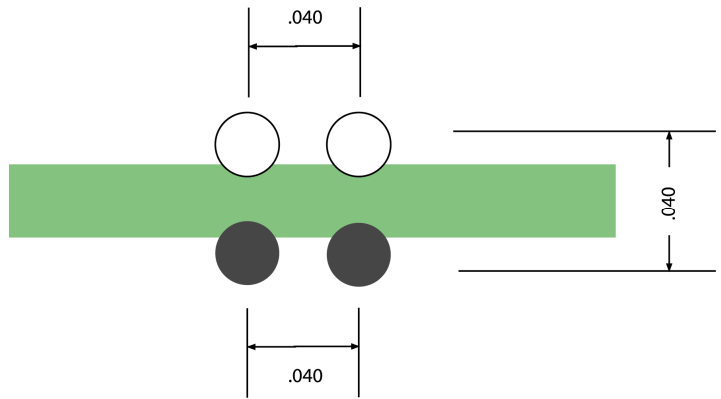

IP-D-100-5

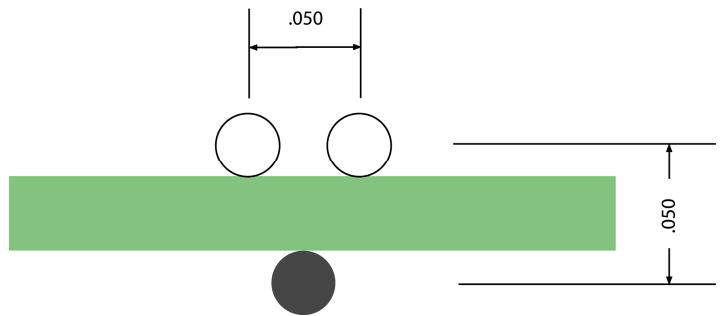

IP-D-100-6

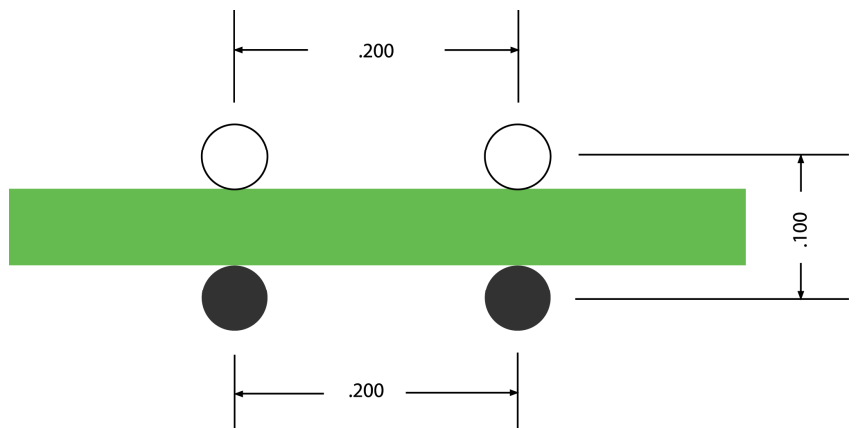

IP-D-100-7

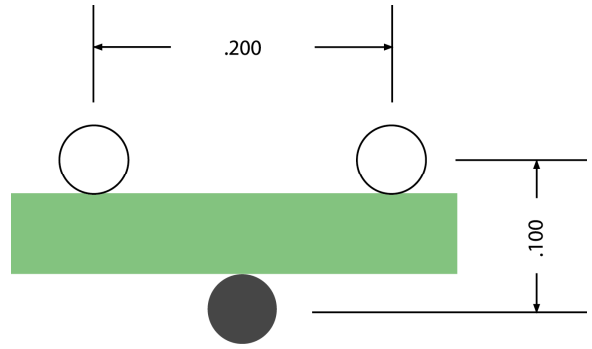

IP-D-100-8

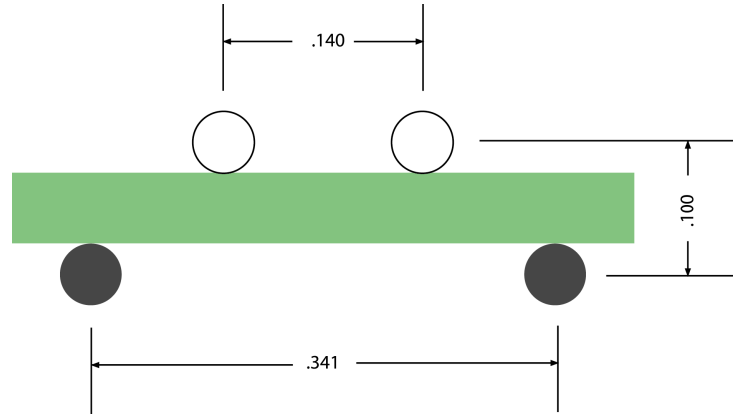

IP-D-100-9

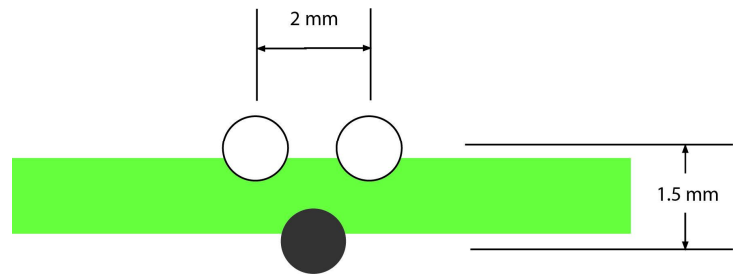

IP-D-100-10

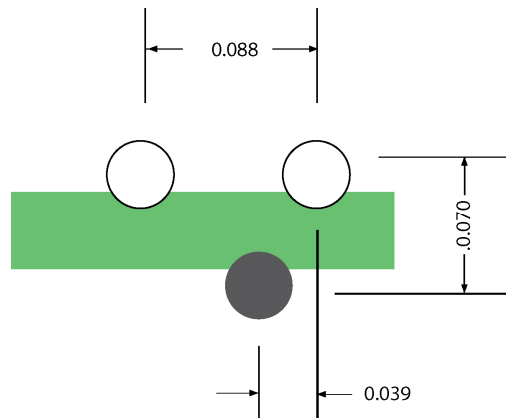

IP-D-100-11

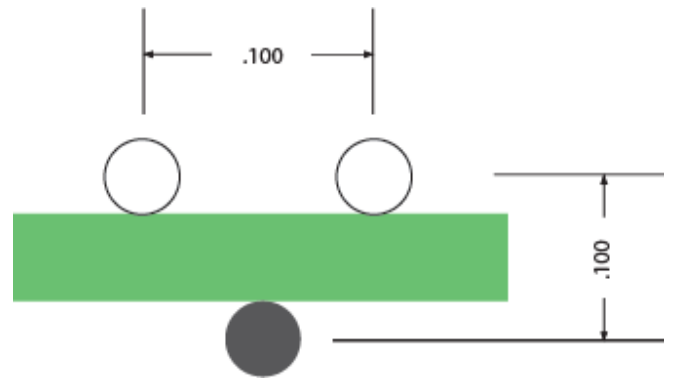

IP-D-100-12

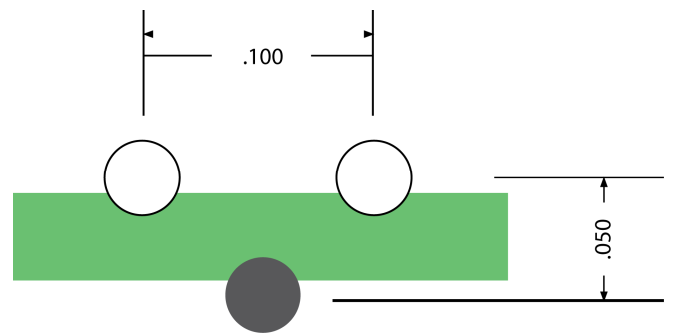

IP-D-100-13

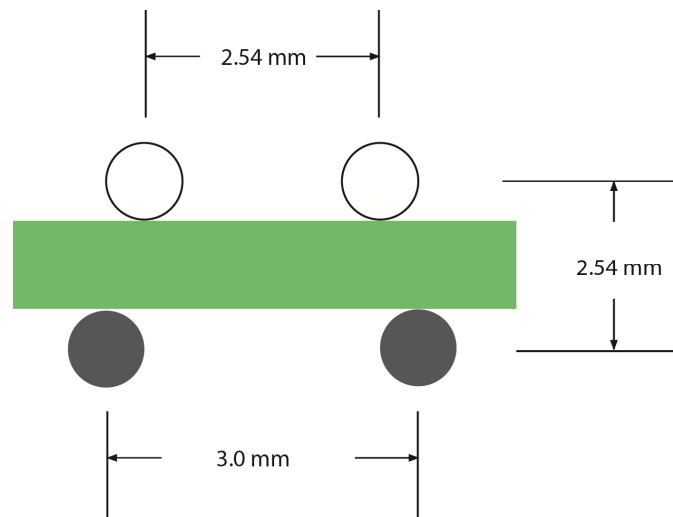

IP-D-100-14

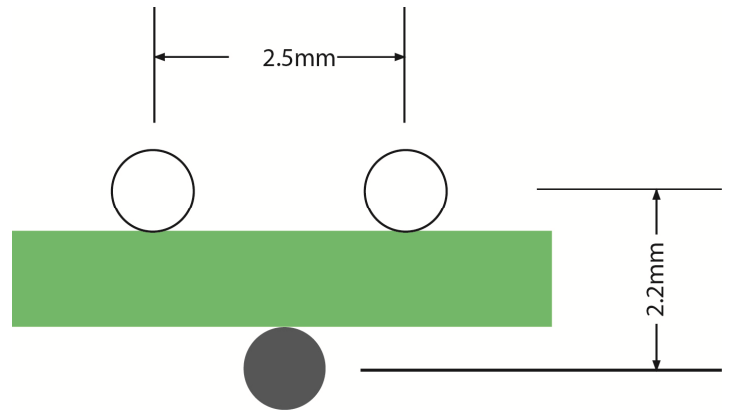

IP-D-100-15

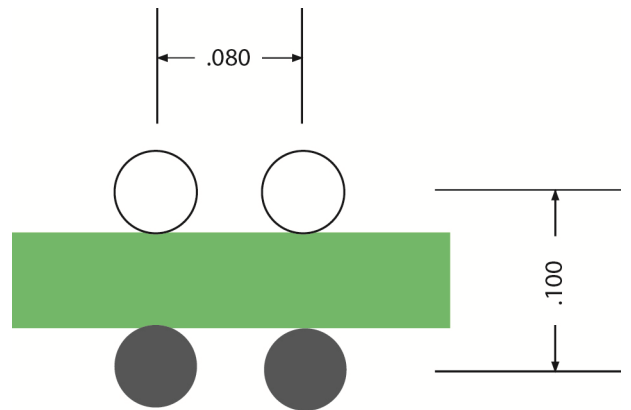

The following list is intended to help customers who are familiar with Polar Instruments probes become familiar with Zmetrix product part numbering. It does not make any representations on probe performances or equivalencies. The user is responsible for making any qualitative comparisons, or evaluations on fitness for use of any Zmetrix probe product with respect to any other Polar Instruments product.

<u>Polar Instruments</u>	<u>Zmetrix</u>
IP-50/0.05"	IP-S-50-3-B
IP-50/0.1"	IP-S-50-1-B
IP-50/0.14"	IP-S-50-2-B
ACC270	IP-D-100-3-B
ACC271	IP-D-100-2-B
ACC274	IP-D-100-1-B